

DISTRICT	COUNTY	ROUTE	SECTION	SHEET
2-0	CENTRE	2006	A01	1 OF 1
HARRIS TOWNSHIP				
REVISION NUMBER	REVISIONS	DATE	BY	

D-9012 CADD (02-90) REVISED (10-04) PLOTTED: \$DATE\$ OPERATOR: SSE FILE NAME: \$FILES\$

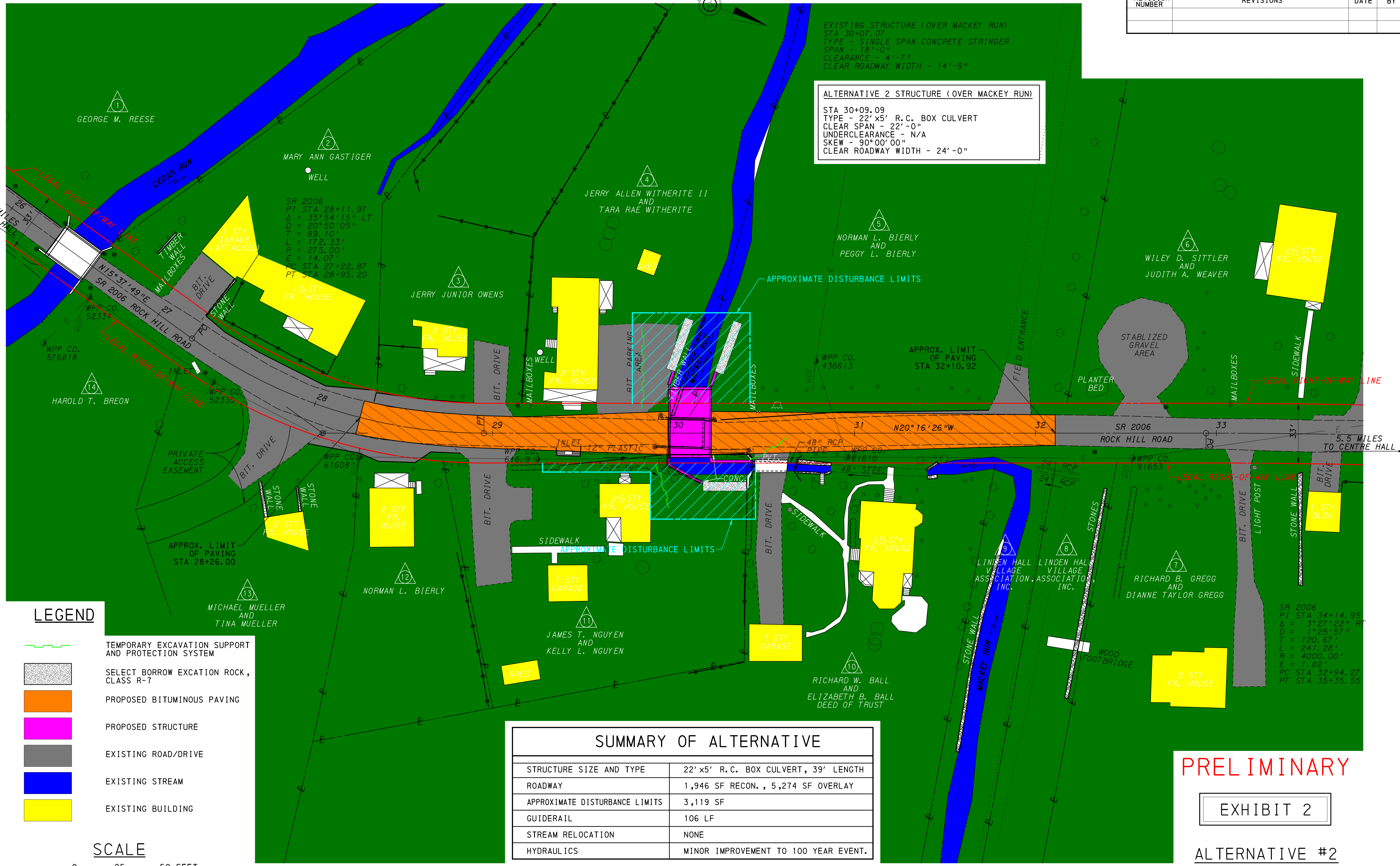

EXISTING STRUCTURE (OVER MACKEY RUN)
 STA 30+07.07
 TYPE - SINGLE SPAN CONCRETE STRINGER
 SPAN - 18'-0"
 CLEARANCE - 4'-7"
 CLEAR ROADWAY WIDTH - 14'-9"

ALTERNATIVE 2 STRUCTURE (OVER MACKEY RUN)
 STA 30+09.09
 TYPE - 22' x 5' R.C. BOX CULVERT
 CLEAR SPAN - 22'-0"
 UNDERCLEARANCE - N/A
 SKEW - 90°00'00"
 CLEAR ROADWAY WIDTH - 24'-0"

LEGEND

	TEMPORARY EXCAVATION SUPPORT AND PROTECTION SYSTEM
	SELECT BORROW EXCAVATION ROCK, CLASS R-7
	PROPOSED BITUMINOUS PAVING
	PROPOSED STRUCTURE
	EXISTING ROAD/DRIVE
	EXISTING STREAM
	EXISTING BUILDING

SUMMARY OF ALTERNATIVE

STRUCTURE SIZE AND TYPE	22' x 5' R.C. BOX CULVERT, 39' LENGTH
ROADWAY	1,946 SF RECON., 5,274 SF OVERLAY
APPROXIMATE DISTURBANCE LIMITS	3,119 SF
GUIDERAIL	106 LF
STREAM RELOCATION	NONE
HYDRAULICS	MINOR IMPROVEMENT TO 100 YEAR EVENT.

PRELIMINARY

EXHIBIT 2

ALTERNATIVE #2

REPLACE EXISTING STRUCTURE AT CURRENT LOCATION WITH A TWO LANE STRUCTURE

